

*John L. Pappeneier*



City of Crown Point  
101 North East Street  
Crown Point, IN 46307

DATE: 01-17-20	REVISIONS AND NOTES: Issued for Construction

109th Ave. East Storm Trunk  
Line and Water Main Project  
Maintenance of Traffic - Detour Route

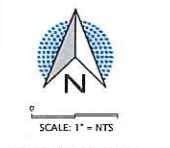

DESIGN BY RLP	DATE 01-2020
PROJECT NO. 19-1009	
6	

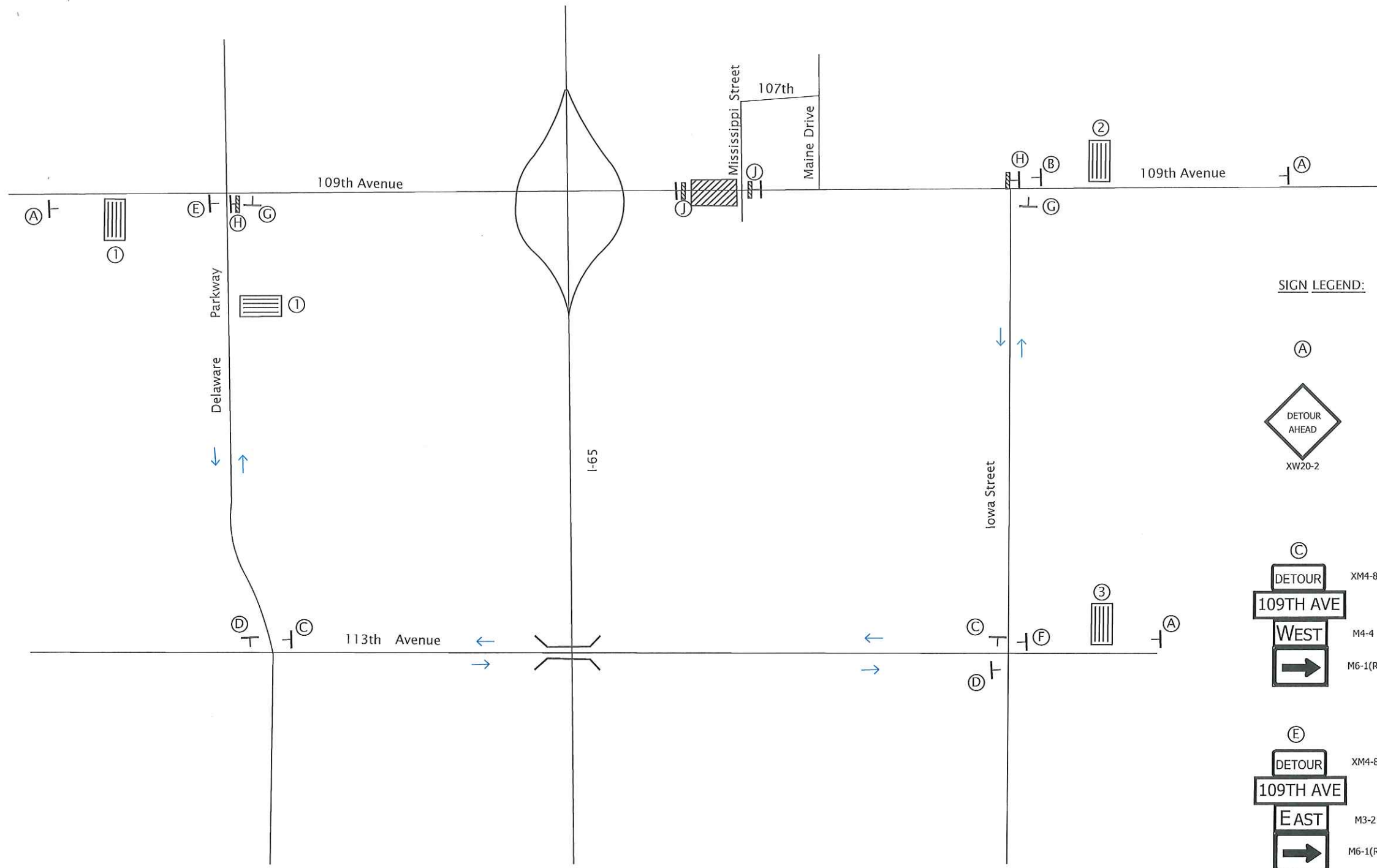

**SIGN LEGEND:**

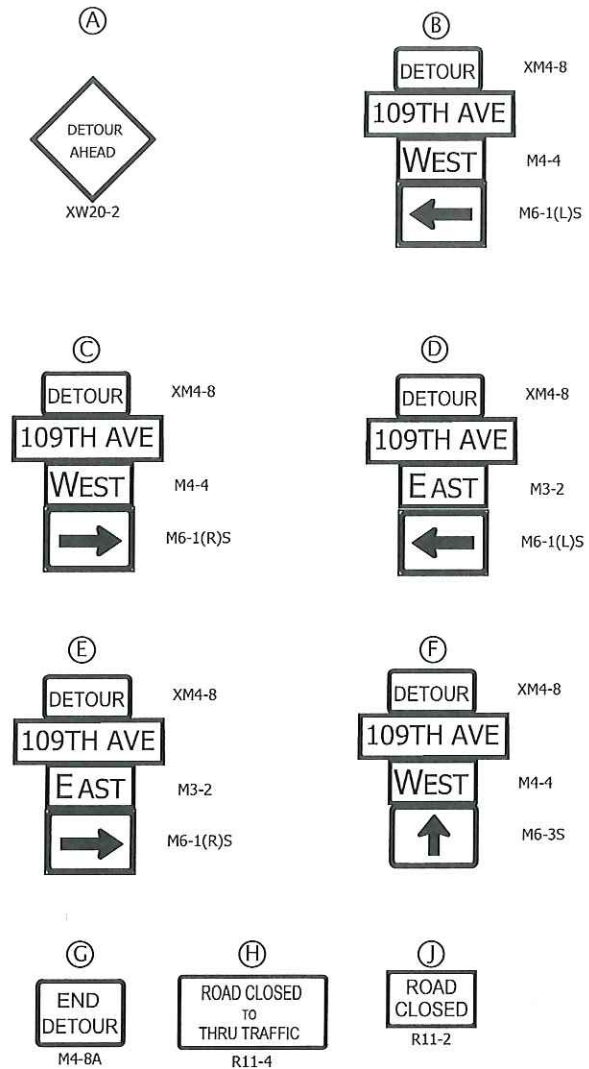

**LEGEND:**

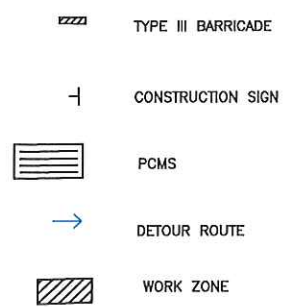

**PCMS MESSAGES:**

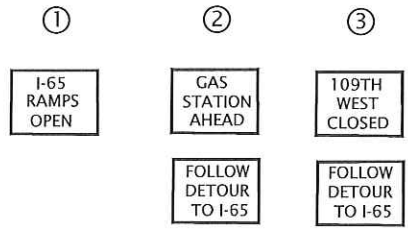

**MOT NOTES:**

- ACCESS TO GAS STATION AT 1601 E. 109TH AVENUE SHALL BE MAINTAINED AT ALL TIMES. ACCESS TO THE RESIDENCE AT 1414 E. 109TH AVENUE SHALL BE MAINTAINED AT ALL TIMES.
- ALL WORK SHALL BE DONE UNDER TRAFFIC WITH THE EXCEPTION NOTED BELOW. DRUMS SHALL BE KEPT AS CLOSE TO THE EDGE OF PAVEMENT AS POSSIBLE. BARRICADES SHALL ONLY BE IN PLACE WHEN NECESSARY.
- THE STORM SEWER CROSSING AT STATION 96+50 ON 109TH AVENUE SHALL BE PERFORMED UNDER A NON-HOLIDAY WEEKEND CLOSURE STARTING NO EARLIER THAN A FRIDAY AT 8:00PM AND ENDING NO LATER THAN THE FOLLOWING MONDAY AT 6:00AM. DETOUR ROUTE DETAILS AS SHOWN IN THIS PLAN SET SHALL BE FOLLOWED. THE CITY SHALL BE PROVIDED ONE WEEK'S NOTICE MINIMUM. MAINTENANCE OF THE ROADWAY PATCHED AREAS SHALL BE INCLUDED IN MAINTENANCE OF TRAFFIC AND WILL NOT BE PAID FOR SEPARATELY.
- FOLLOW THE 2011 IMUTCD AND THE INDOT STANDARD SPECIFICATIONS AND DRAWINGS CURRENT AT THE TIME OF BIDDING.